

LS50 Wireless



LS50 Wireless
Greatness, amplified.

At KEF, we believe that music should not just reach your ears, but your heart. Our passion for music drives us in search of quality sound, inspiring constant innovation. We develop tools that deliver music faithfully and honestly, in all its glory. We believe that everyone deserves to experience music as it was meant to be heard.



The LS50 Wireless
Audiophile Music System



The Greatness Continues

The legendary LS3/5A was the original mini monitor that transformed the audio experience back in 1975. It was designed at the BBC, utilising as core components the KEF B110 bass/midrange unit and KEFT27 treble unit, and demonstrated a total understanding of the art and science of speaker design.

To celebrate KEF's 50th anniversary, a new classic was born: the LS50. Taking its inspiration from the acclaimed performance of the LS3/5A, the LS50 passive speakers brought the professional studio monitor concept into the home and was a pioneer in enabling everyone everywhere to experience great sound. This multiple award-winning speaker gained consistent renown and recognition for its accurate yet rich, multi-dimensional sound that is out of all proportion to its size.

"... a cracking little speaker of which KEF's design engineers must be most proud. Sweetly voiced yet highly revealing of source quality, it surprises and delights in equal measure. And boy does it sound big, defying its compact dimensions."

- Hi-Fi News & Record Review

"The KEF LS50s have set a ridiculously high benchmark and it is going to take a superhuman effort to top them."

- What Hi-Fi? Sound and Vision

"The LS50 is nothing short of a masterpiece of a minimonitor; priced so that anyone serious about audio can buy a pair — and probably should, if only to know how great a small speaker can be. The LS50 is one of their best speakers yet, and one of their best values; it's proof that, as it ages, this company seems to get better and better."

- SoundStage!HiFi



LS3/5A



LS50

Since that landmark launch, KEF has stepped up to the challenge of creating tools for the digital age. Following the same principle of quality sound, the LS50 Wireless is a complete, fully active music system that brings Hi-Fi sound to the new generation of digital music lifestyles.



LS50 Wireless



A Complete System for High Resolution Music

The beauty of the LS50 Wireless is the combination of simplicity and sophistication. It is a complete system that takes musical enjoyment to the next level where sound and ease-of-use match the modern music lifestyle.

With its LS50 pedigree, all the winning acoustic features and benefits of the passive loudspeaker are retained in the LS50 Wireless system. The FEA-designed cabinet, constrained layer damping panels, driver, curved baffle as well as the elliptical flexible sound port are all part of the LS50 Wireless to prevent cabinet vibrations, radiating sound, resonances and colouration.

The additional audiophile grade amplification and sound processing, as well as comprehensive connectivity, makes the LS50 Wireless a total music system.

The LS50 Wireless delivers audiophile-grade sound with an array of sophisticated components built in:

- Dedicated power amps per driver channel
- Dedicated DSP crossover per channel
- Dedicated DAC per channel
- Streaming pre-amplifier

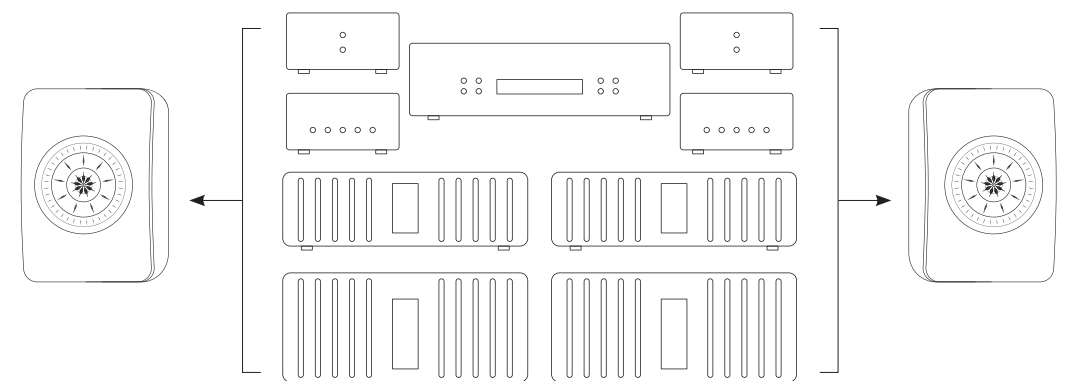

Uni-Q: Every Spot Is The Sweet Spot

Our patented Uni-Q technology places the tweeter in the acoustic centre of the bass / midrange cone so that both act as a single point source that disperses the sound more evenly throughout the room than any conventional speaker. This means that you get the full enjoyment from your music no matter where you sit.

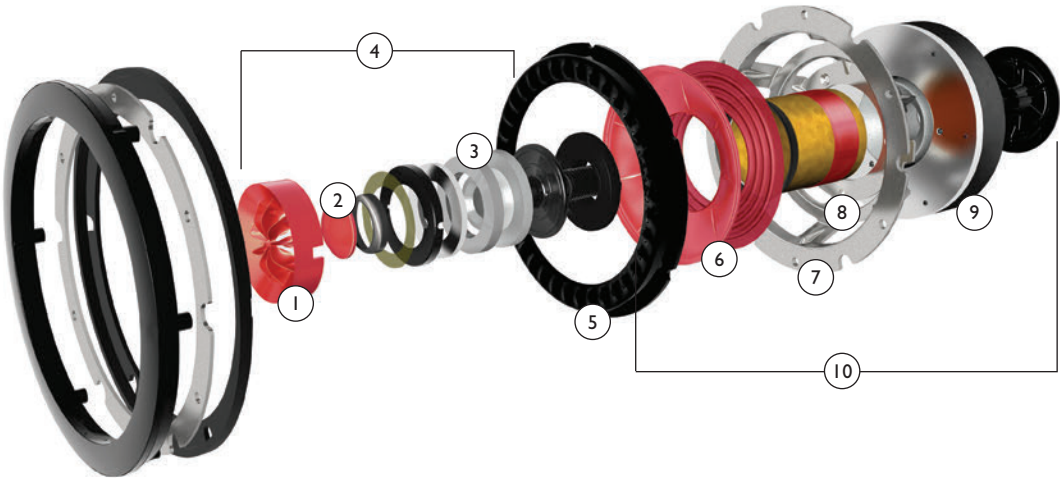

- ① **Tangerine waveguide**
Increases the dispersion of the tweeter. Energy is distributed more evenly across a wider angle, reducing the traditional "sweet spot effect"

② **Optimum dome shape and stiffened dome technology**
Creates a structure that is so stiff, it operates as a pure piston over its entire working range. The dome resonance for the tweeter is at 40kHz which is beyond audible range

③ **Large neodymium magnet**

④ **Vented tweeter**
- ⑤ **Z-flex cone surround**
Smooth physical transition between cone and cabinet front panel

⑥ **Stiffened magnesium / aluminium alloy cone**
Light, stiff and physically smooth

⑦ **Die-cast aluminium chassis**

⑧ **Break-up control**
Damping of first HF break-up peak

⑨ **Large ferrite magnet**

⑩ **LF/MF driver**



Crossover Timing Correction: Every Note at the Same Time

Passive crossovers cause the signal to be time-smeared. Our advanced time-correcting DSP crossover solves this problem and ensures “close-to-perfect” time alignment between low and high frequencies so that every note hits your ears at the same time. This was a theoretical ideal in the past, and perfectly accurate sound could only be experienced within a small “sweet spot”. With LS50 Wireless' advanced time-correcting DSP crossover and the unique sound dispersion abilities of our Uni-Q technology, time-corrected accurate sound can be achieved in different types of rooms. This is a feature that cannot be reproduced by any other active speaker.

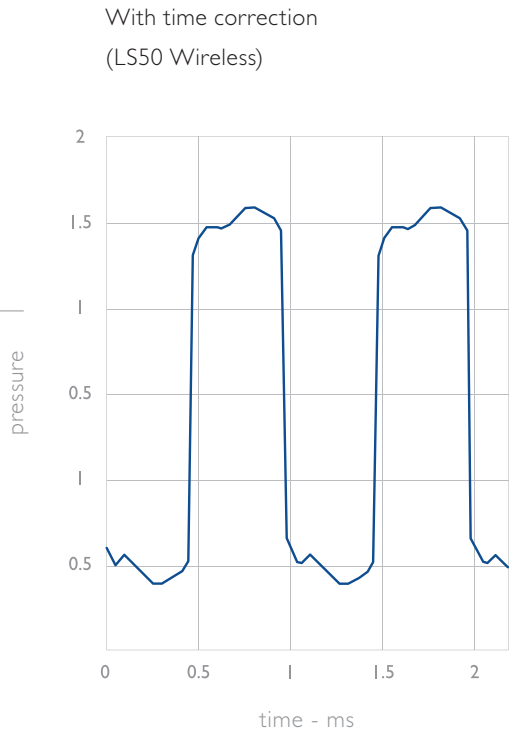
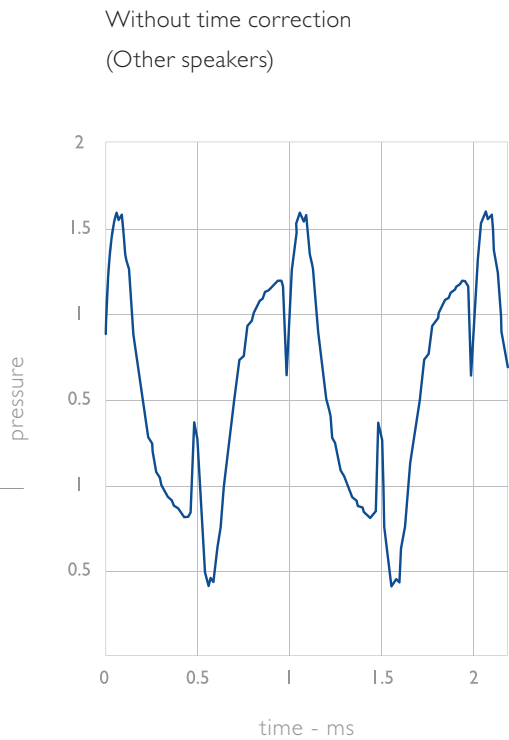
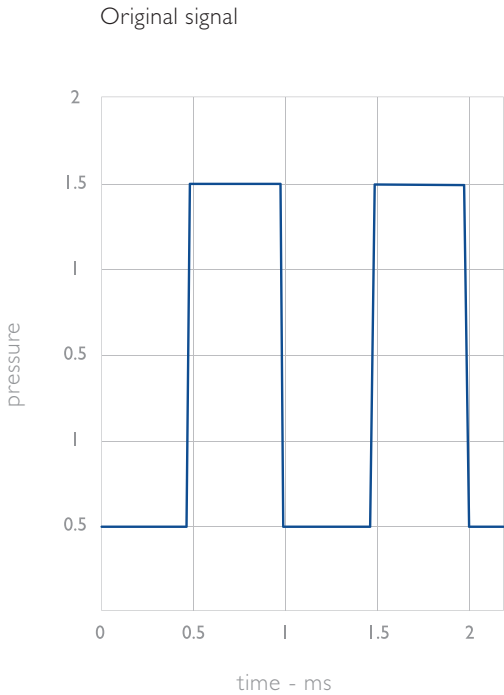

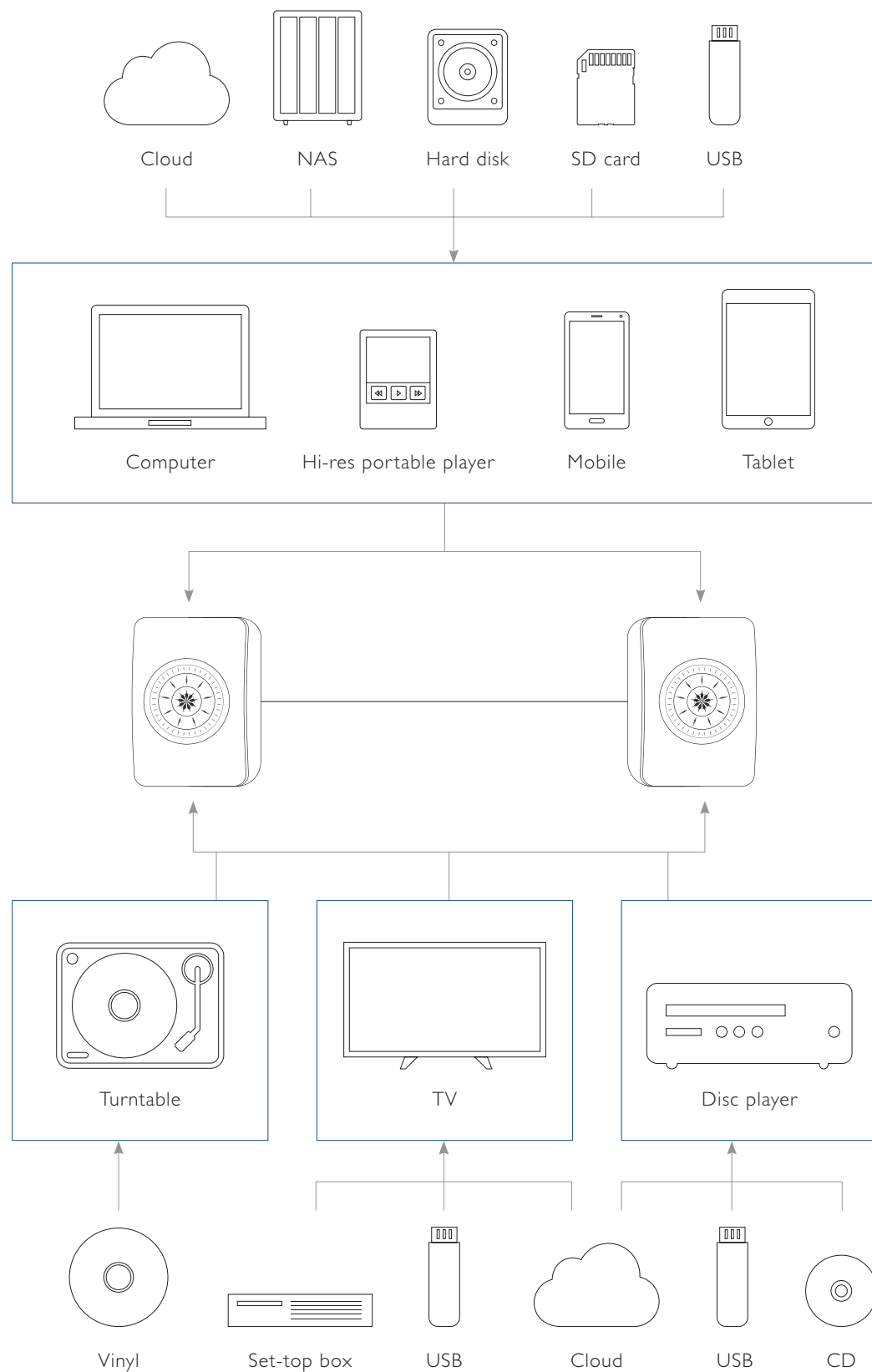

Comprehensive Connectivity

There is a full range of options to connect your device to the LS50 Wireless: Bluetooth 4.0 with aptX® codec (max. 8 devices), Asynchronous USB Type B, TOSLINK Optical and RCA Analog Line Level Input.

Placement Flexibility

Adjust how the LS50 Wireless sounds using a selectable EQ tuned to compensate for different mounting scenarios, creating more options for placement and positioning. Regardless of placement, Uni-Q technology disperses sound evenly for total listening enjoyment.

Excellent Compatibility

With all these options to connect to the LS50 Wireless, you can enjoy your music, no matter how you store it.

Specifications



Gloss Black/Blue



Gloss White/Copper



Titanium Grey/Red

Drive units	Uni-Q driver array: HF: 25mm (1in.) vented aluminium dome LF/MF: 130mm (5.25in.) magnesium/aluminium alloy
Frequency Range (-6dB) Measured at 85dB/1m	40Hz – 47kHz (More bass extension) 43Hz – 47kHz (Standard) 46Hz – 47kHz (Less bass extension) Depending on speaker settings
Frequency Response (±3dB) Measured at 85dB/1m	45Hz – 28kHz (More bass extension) 50Hz – 28kHz (Standard) 61Hz – 28kHz (Less bass extension) Depending on speaker settings

Max Output (SPL)	106dB
Amplifier Output Power	LF: 200W HF: 30W
Resolution	Up to 24 bit
Sampling Rate	Up to 192kHz (USB Type B) Up to 96kHz (TOSLINK Optical)
Network	Wi-Fi 802.11 a/b/g/n, Dual-band 2.4GHz/ 5GHz 10/100 Mbps RJ45 Ethernet
Audio Inputs	Bluetooth 4.0 with aptX® codec (Max. 8 devices) Asynchronous USB Type B TOSLINK Optical RCA Analog Line Level Input
Audio Output	RCA analog for subwoofer connection
Dimension (H x W x D)	300 x 200 x 308mm (11.8 x 7.9 x 12.1in.)
Weight	Left Speaker 10.0kg (22.0lbs) Right Speaker 10.2kg (22.5lbs)
Power Input	100 – 240VAC 50/60Hz



The Search For True Sound

KEF, one of the originators of British Hi-Fi sound, was founded in 1961 by Raymond Cooke OBE (1925 - 1995). It was initially headquartered in a Nissen Hut on the premises of Kent Engineering & Foundry (from where the name KEF is derived). Cooke, an ex-BBC Electrical Engineer, was keen to experiment with new materials and technologies in order to create products with superior acoustic quality that could reproduce recordings as natural as the original performance. Made by music lovers from the very beginning, the pioneering inventiveness of KEF loudspeakers was undeniable, and audiophiles around the world have revered KEF for its innovative, high-performance loudspeakers.

Now in its 6th decade, KEF develops world-beating products with its R&D and Engineering still based in Maidstone, Kent. Scientific innovation at KEF continues to underwrite its reputation as the audiophile's ultimate loudspeaker manufacturer.

“This is for Loudspeakers?”

-HMThe Queen

“High-Fidelity Loudspeakers, Ma’am.”

-Raymond Cooke, on receiving his OBE



